



## 3 Jasmine Gardens

Chaddlewood, Plymouth, PL7 2JD

£250,000



Beautifully presented and tucked away in a quiet cul-de-sac, this end-terraced house boasts a spacious kitchen/diner, a generous lounge opening to a landscaped rear garden, 3 well-proportioned bedrooms and 2 allocated private parking spaces. Within easy reach of local shops, schools and amenities.



## JASMINE GARDENS, PLYMPTON, PLYMOUTH PL7 2JD

### ACCOMMODATION

Covered entrance porch with storage cupboard. Composite door opening into the entrance hall.

### ENTRANCE HALL 7'1 x 5'4 (2.16m x 1.63m)

Stairs rising to the first floor. Doors opening to the downstairs cloakroom and kitchen/diner.

### DOWNSTAIRS CLOAKROOM

Fitted with a 2-piece white suite comprising a low-level wc and mini wash handbasin with mixer tap and cupboard below. Obscured-glass uPVC double-glazed window.

### KITCHEN/DINER 14'11 x 13'5 (4.55m x 4.09m)

The kitchen area is well-fitted with an extensive range of units comprising eye-level wall cupboards, a full-length larder cupboard, matching base cupboards and drawers with roll-edged laminate work surfaces over and a tiled surround, incorporating a stainless-steel one-&-a-half drainer sink unit with mixer tap. uPVC double-glazed window overlooking the front. Plumbing for dishwasher and washing machine. Large space for a range cooker (which is included). Extractor canopy over. Large space for a double fridge/freezer (also included). The kitchen houses the gas boiler which serves both the central heating and domestic hot water. Wood-effect vinyl floor covering. Good-sized under-stairs storage cupboard. Door to the lounge.

### LOUNGE 16'9 x 10' (5.11m x 3.05m)

Wood-effect floor covering. uPVC double-glazed window overlooking the rear garden. uPVC double-glazed patio door opening onto the rear garden.

### FIRST FLOOR LANDING 11'3 x 6'5 (3.43m x 1.96m)

Modern panel doors leading off to all rooms. Built-in storage cupboard.

### BEDROOM ONE 11'4 x 9'7 (3.45m x 2.92m)

Built-in double wardrobe with sliding doors. uPVC double-glazed window overlooking the front.

### BEDROOM TWO 11'7 x 8'4 (3.53m x 2.54m)

Built-in double wardrobe. uPVC double-glazed window overlooking the rear. Hatch with retractable ladder to the insulated, part-boarded roof space.

### BEDROOM THREE 8' x 7'2 (2.44m x 2.18m)

Wood-effect laminate floor. uPVC double-glazed window overlooking the rear.

### BATHROOM 6'8 x 6'3 (2.03m x 1.91m)

A well-appointed bathroom, fitted with a 3-piece white suite, comprising a panel bath with fully-tiled surround, mains Victorian-style shower with rose, hose and shower screen, vanity wash handbasin with mixer tap and double cupboard below and low-level wc. Fitted mirrored bathroom cabinet. Chrome heated towel rail. Extractor fan. Obscured-glass uPVC double-glazed window.

### OUTSIDE

To the front a paved pathway leads to the front door, with a small area of lawn and slate chippings. 2 private, allocated parking spaces. A pathway runs along the side of the property, which belongs to the owners but has a 'right of way' for the neighbouring property. From there a gate opens into the rear garden which is fully-enclosed by timber fencing. It has been recently re-landscaped with a lawned area, a mature cherry tree and a Riven slab patio with an outside light.

### COUNCIL TAX

Plymouth City Council  
Council Tax Band: B

### SERVICES

The property is connected to all the mains services: gas, electricity, water and drainage.

## Area Map



## Floor Plans

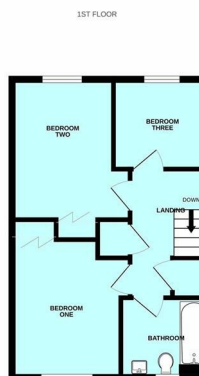
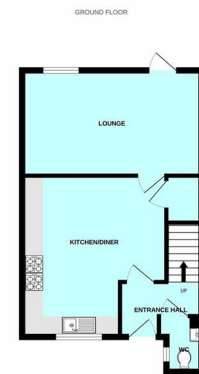

## Energy Efficiency Graph

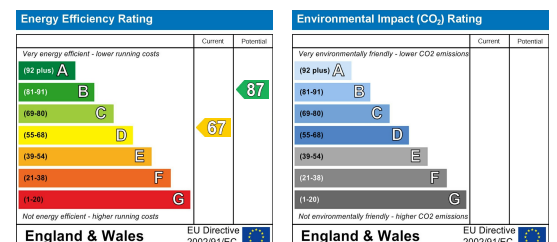

These particulars, whilst believed to be accurate are set out as a general outline only for guidance and do not constitute any part of an offer or contract. Intending purchasers should not rely on them as statements of representation of fact, but must satisfy themselves by inspection or otherwise as to their accuracy. No person in this firm's employment has the authority to make or give any representation or warranty in respect of the property.